

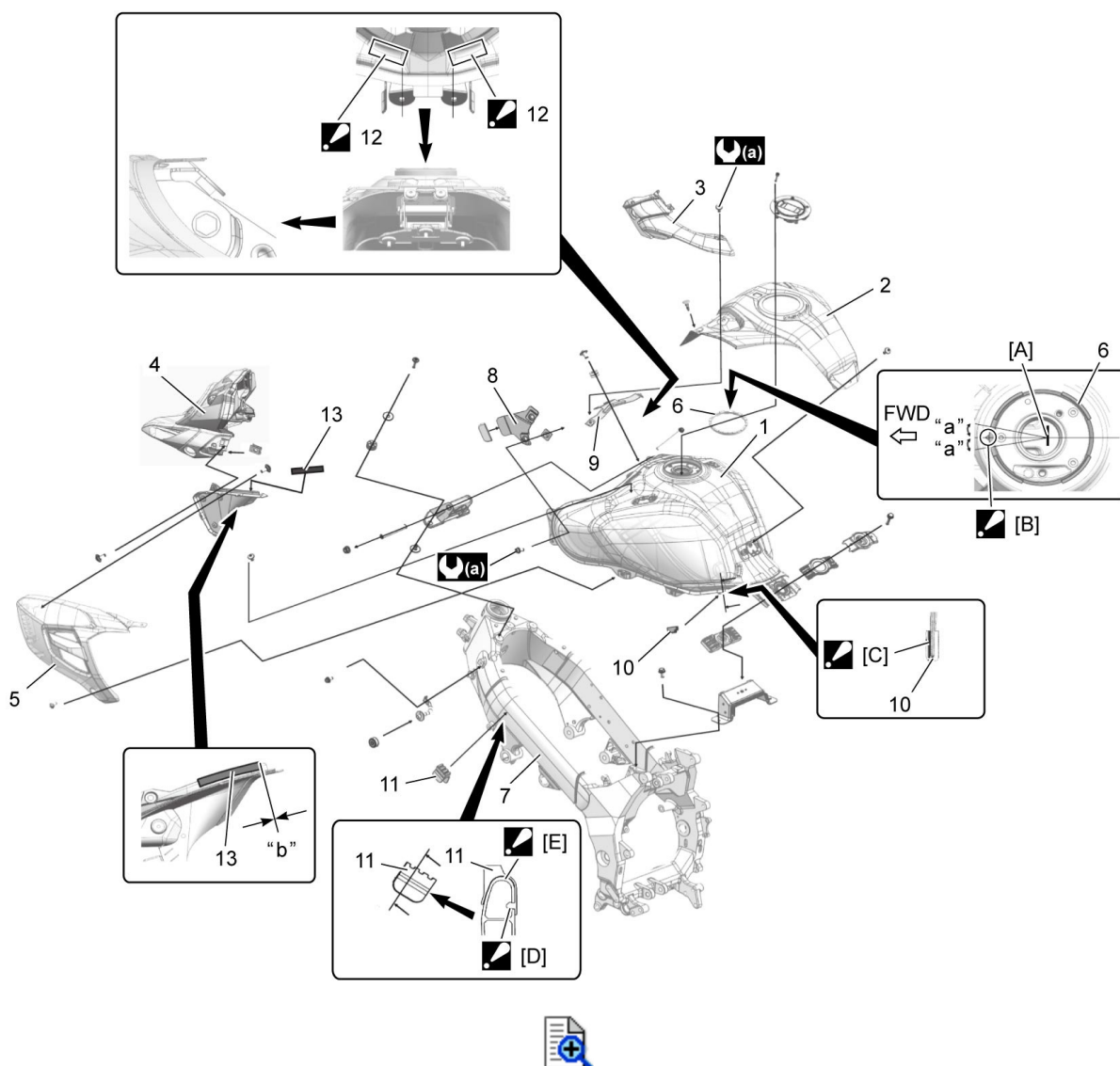

Fuel Tank Construction



[A]:	Center position	3.	Side cowling cover	10.	Fuel tank cover cushion
[B]:	Set the projection of fuel tank cover molding aligning with center position (less than 10°).	4.	Body cowling	11.	Fuel tank side cushion
[C]:	Adhere the cushion with a adhesive.	5.	Fuel tank side cover	12.	Fuel tank cushion : Stick the cushion aligning with this position.
[D]:	Install the boss of cushion.	6.	Fuel tank front cover molding	13.	Fuel tank molding
[E]:	Stick the cushion with a double sided tape.	7.	Frame	"a":	10°
1.	Fuel tank	8.	Fuel tank cover bracket	"b":	0 - 10 mm (0 - 0.4 in)
2.	Fuel tank center cover	9.	Front cover bracket	(a):	5.5 N·m (0.55 kgf-m, 4.0 lbf-ft)